

# Au.diSlot™ data sheet

## Product Description

As an alternative to traditional circular hole perforations, Au.diSlot™ features 'slot' type perforations with a complementing selection of decorative surface finishes. A selection of standard slotting patterns are available, and when paired with our optional Integrated Acoustic Backing (IAB) this product provides excellent acoustic performance.

## Product Features & Variations

- Select your preferred veneer, plastic laminate, paint, or stain finish to match with other building elements
- Largest range of slotted patterns
- Custom perforation patterns available
- Standard nominal panel sizes up to 1524 x 3048mm (5' x 10')
- Custom nominal panel sizes up to 1524 x 3658mm (5' x 12')
- Standard black Integrated Acoustic Backing (IAB)
- Optional white Integrated Acoustic Backing (IAB) - minimums may apply

## Material Sizes

- Standard nominal sizes, available in MDF, FR MDF, and MR MDF
  - Thickness: 19mm (3/4") and 16mm (5/8")
  - Width: 1219mm (4') and 1524mm (5')
  - Length: 2438mm (8') and 3048mm (10')
- Veneers in lengths over 2438mm (8') are limited and subject to current availability
- Contact Atkar Technical Staff for additional material sizes.

## Finish Options

- Natural or Reconstituted Veneers with clear or stain finish
- Plastic Laminates
- Paints

## Substrates

- MDF
- MDF fire rated (FR MDF)
- MDF moisture resistant (MR MDF)

## Perforation Patterns

Two standard slotting patterns are available—AS11, with 8 columns of short slots per 1219mm (4') wide panel, and AS26, with 4 columns of long slots per 1219mm (4') wide panel. Both patterns are available in a variety of slot widths, as indicated in the table below. Standard perforation patterns have slots running the width of the panel. For non-standard slotting patterns, including patterns with slots running the length of the panel, consult Atkar Technical Staff.

Slot Width		Slot Type AS11			Slot Type AS26	
		AS11-16	AS11-32	AS11-64	AS26-32	AS26-64
mm	Code					
6	60	27.2%	13.6%		16.2%	
9	90		20.3%		24.2%	12.1%
12.5	125		27.9%	14.0%		16.8%
16	160			17.8%		21.4%
19	190			21.0%		25.3%

Slot Type AS11 (on a 4' wide panel)

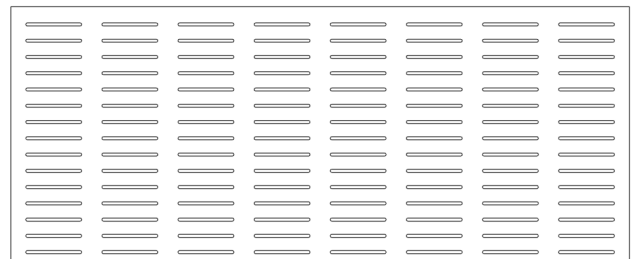

Slot Type AS26 (on a 4' wide panel)



## Margin Options

Standard margins at the side of the panels are about 29.5mm (1-3/16"). Standard margins at the ends of the panel are at least 27mm (1-1/16"). Consult Atkar technical staff for custom margin options.

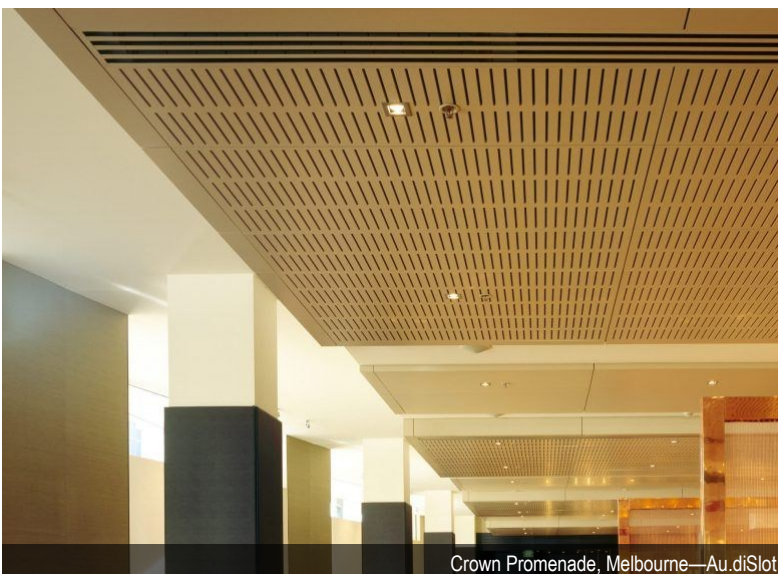

Crown Promenade, Melbourne—Au.diSlot

Due to continual product improvement, the information in this publication is subject to alteration without notice.

# Au.diSlot™ data sheet

## Acoustics

There are many factors that influence the NRC of Au.diSlot™. You can specify your Au.diSlot™ to be installed with acoustic insulation. Acoustic duct liner blankets or boards can be purchased through Atkar or a local vendor. Depending on open area, specified insulation, and air gap behind the panel, ratings can range from 0.55 NRC to 0.80 NRC.

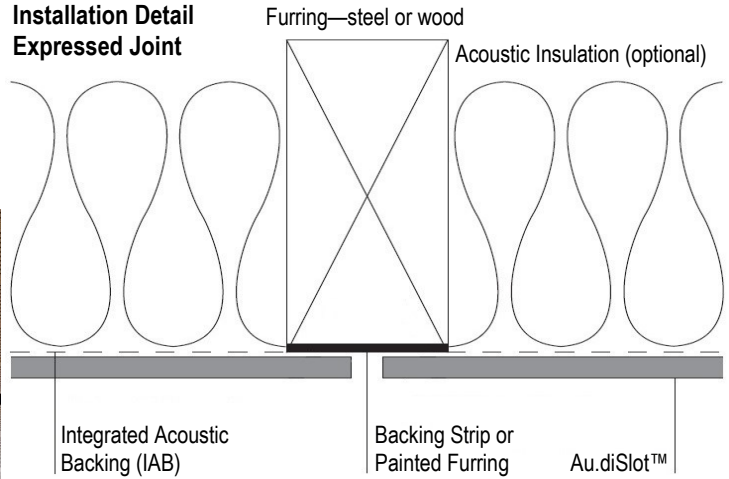

## Installation System

- Z-bar/Z-clip system—with lip for ceiling applications
- PS3 recessed mounting system—insert fastener in perforation and secure panel through plywood mounting strip
- Face-fastened—matching or contrasting fasteners (consult Atkar Technical Staff for fastener finish options)

## Sustainability

Refer to Environmental Data Sheet. Consult Atkar Technical Staff to determine which LEED credits will be available for your project.



## How to Specify

- Slot Length
  - Slot Length in cm
  - 11 or 26
- Slot Spacing (on centre)
  - Slot spacing (on centre) in mm
  - 16 or 32 or 64
- Slot Width
  - Perforation diameter in mm, 1 decimal place
  - e.g. 12.5mm (1/2") = 125, 9mm (3/8") = 90

## EXAMPLE

Slot Length      Slot Width

AS11-32/90

Slot Spacing (on centre)

- Au.diSlot™ Panel
- 110mm long slot
- 32mm on-centre slot spacing
- 9mm wide slot

## Fire Rating

Standard Au.diSlot™ components meet or exceed Class C fire rating. If Class A fire rating is required, all components of the product will conform to CAN/ULC test standards.

- FR MDF: CAN/ULC-S102 & ASTM-E84 Class A
- Standard IAB: CAN/ULC-S102 & ASTM-E84 Class A



Due to continual product improvement, the information in this publication is subject to alteration without notice.